

UNIT NUMBERS

308
408
508
608
708
808
908
1008
1108
1208
1308
1408
1508
1608
1708
1808
1908
2008
2108
2208
2308

LIVING AREA	=	1290 S.F.
GULFSIDE BALCONY	=	193 S.F.
TOTAL	=	1483 S.F.

NOTE: SQUARE FOOTAGE IS MEASURED PAINTED SURFACE TO PAINTED SURFACE OF DEMISING WALLS AND TO CENTERLINE OF SLIDING GLASS DOORS.

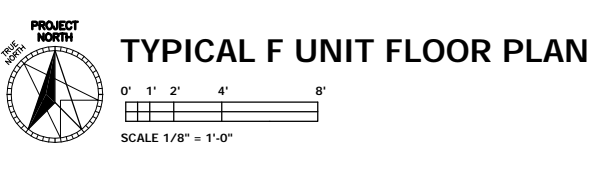

TYPICAL F UNIT FLOOR PLAN

KEY

	INDICATES TILED AREA (TILE NOT DRAWN TO SCALE)
--	--

<p>A3.06</p> <p style="font-size: small;">Sequence XX of XX total</p>	<p style="font-size: x-small;">Sheet</p> <p style="font-size: x-small;">Checked M. M.</p> <p style="font-size: x-small;">Drawn G. H.</p> <p style="font-size: x-small;">Date 11-13-03</p> <p style="font-size: x-small;">Project HDPR-203</p>	<p style="font-size: x-small;">TYPICAL F UNIT FLOOR PLAN</p>	<p style="font-size: x-small;">Site 310 Panama City Beach, Florida 32413 1000 Highway 90 Panama City Beach, Florida Telephone (202) 998-8625</p> <p style="font-size: x-small;">HORIZON DESIGN LLC</p>	<p style="font-size: x-small;">Prepared by MAJESTIC BEACH TOWERS WILLEMIS BEACH 1000 Highway 90 Panama City Beach, Florida</p>	<p style="font-size: x-small;">Panama City Beach, Florida</p> <p style="font-size: x-small;">11-13-03</p> <p style="font-size: x-small;">Preliminary Not for Construction</p>
--	---	--	---	---	---

Majestic Beach Towers

Condominium Tower Stage II

Panama City Beach, Florida