

Copyright © 2003 Horizon Design LLC

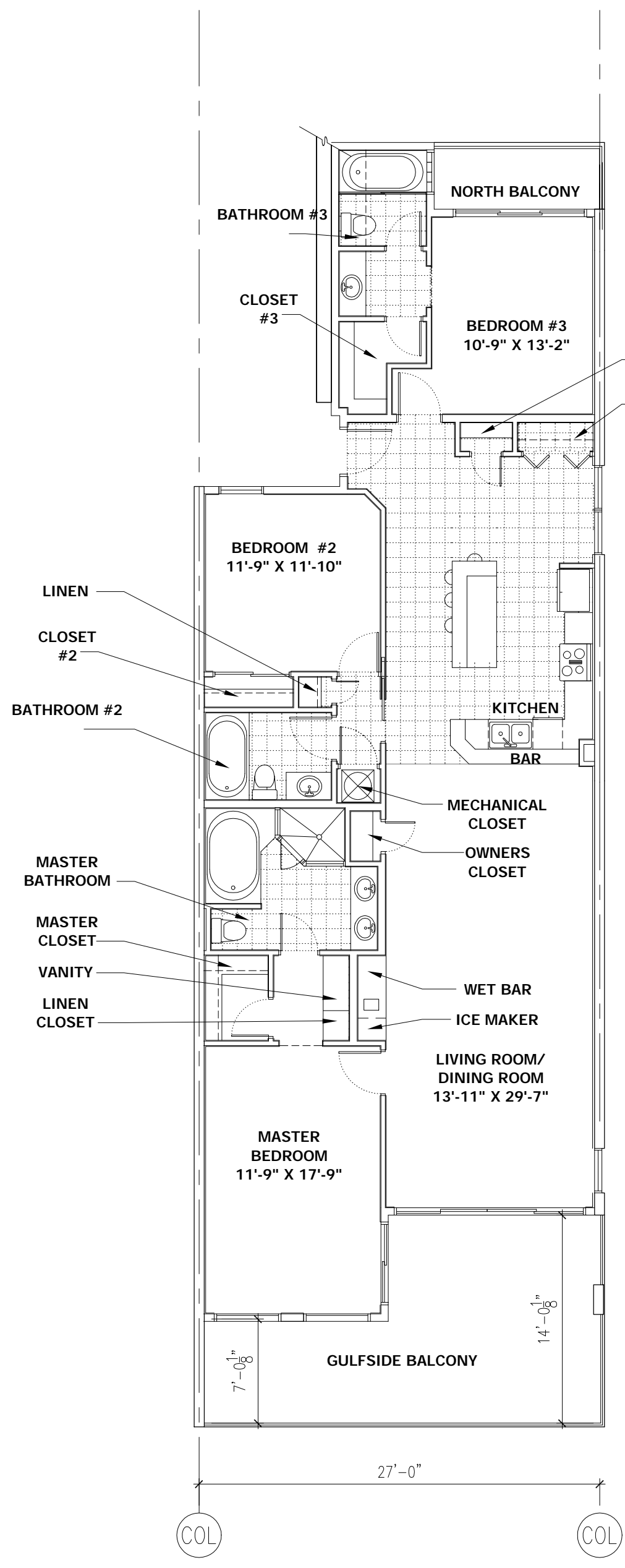

UNIT NUMBERS

- 309
- 409
- 509
- 609
- 709
- 809
- 909
- 1009
- 1109
- 1209
- 1309
- 1409
- 1509
- 1609
- 1709
- 1809
- 1909
- 2009
- 2109
- 2209
- 2309

LIVING AREA = 1688 S.F.
GULFSIDE BALCONY = 306 S.F.
NORTH BALCONY = 54 S.F.

TOTAL = 2046 S.F.

NOTE: SQUARE FOOTAGE IS MEASURED PAINTED SURFACE TO PAINTED SURFACE OF DEMISING WALLS AND TO CENTERLINE OF SLIDING GLASS DOORS.

KEY	
	INDICATES TILED AREA (TILE NOT DRAWN TO SCALE)

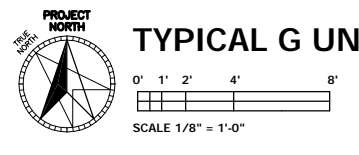

TYPICAL G UNIT FLOOR PLAN

<p>Project: HDPR-203 Date: 11-13-03 Drawn: G.H. Checked: M.M. Sheet: A3.07 Sequence: XX of XX total</p>	<p>Prepared by: HORIZON DESIGN LLC 1001 S.W. 10th Ave. Suite 310, Panama City, FL 32404 Telephone: (904) 998-8625</p>	<p>MAJESTIC BEACH TOWERS WILFRED CORP. 1111 E. 10th St. Panama City, FL 32404</p>	<p>Majestic Beach Towers Condominium Tower Stage II Panama City Beach, Florida</p>	<p>Preliminary Not for Construction 11-13-03</p>
--	--	---	--	---