

Copyright © 2002 Crawford McMillens Halcher Architects, Inc.

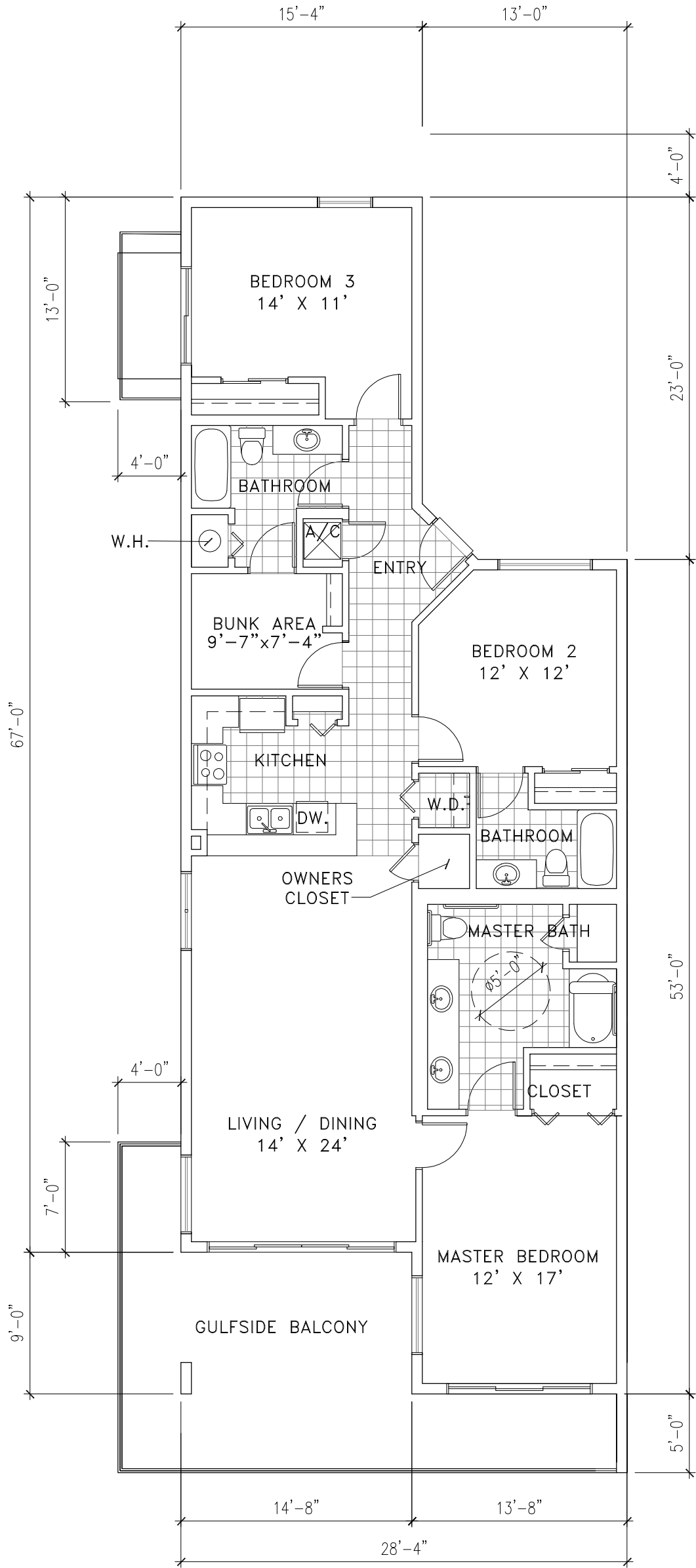

UNIT NUMBERS

- 701
- 801
- 1301
- 2101
- 2301

LIVING AREA = 1617 S.F.
GULFSIDE BALCONY = 353 S.F.
NORTH BALCONY = 129 S.F.

TOTAL = 2099 S.F.

NOTE: SQUARE FOOTAGE IS MEASURED PAINTED SURFACE TO PAINTED SURFACE.

KEY

INDICATES TILED AREA (TILE NOT DRAWN TO SCALE)



TYPICAL HANDICAP ACCESSIBLE A UNIT FLOOR PLAN

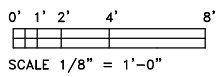

Project	PR02-105
Date	12-12-02
Drawn	G H
Checked	M M
Sheet	HC 4.01
Sequence	XX of XX total

Prepared by



Crawford McMillens Halcher
 Architects, Inc.
 500 Professional Park Drive
 Birmingham, Alabama 35243
 Telephone: (205) 899-5099

Sheet Title
 HC UNIT A
 FLOOR PLAN

Majestic Beach Condominiums Stage I
Panama City Beach, Florida

**Preliminary
 Not for
 Construction**
 12/12/02